

# SPECIFICATIONS

## SUBSEA PRESSURE SENSOR RS232 MP AE



### Description

The Subsea Pressure Sensor is available in a variety of pressure ranges and comes with a serial RS232 interface.

The Subsea Pressure Sensor is designed for use in almost all subsea applications, and offers a reliable pressure measurement, even under harsh environmental conditions. Excellent vibration stability, robust construction, and a high degree of EMI protection equip the pressure transmitter to meet the most stringent industrial requirements.

### Features

- RS232 serial interface
- High accuracy
- Wetted parts made of stainless steel
- Compact and robust design
- Pressure ranges from 1000 bar
- For temperatures up to 70 °C
- 3000-meter depth rating
- Service and user friendly

# SPECIFICATIONS

## SUBSEA PRESSURE SENSOR RS232 MP AE

### General Technical Specifications

Type		Subsea Pressure Sensor RS232 MP AE
Dimensions	mm	Ø40x161
Weight	g	~1000
Temperature Operational (ambient)	°C	0 to +70
Temperature Storage	°C	-20 to +70
Temperature Media	°C	-40 to +125
Housing material		AISI 316L

### Electrical

Supply Voltage	VDC	24VDC (11-30)
Power Consumption	W	~1W

### Communication

RS232	kbps	9.6 – 230.4 (default 115.2)
-------	------	-----------------------------

### Performance

Analog Input Resolution	bit	15 (32767)
-------------------------	-----	------------

### Ordering Part Numbers

Description	Part Number
0 – 1000 bar	120262
0 – 1600 bar	121639
0 – 2200 bar	121640

### Accessories

Fitting BSP 1/8" Plug Hex w/Seal SS	118503
-------------------------------------	--------

# SPECIFICATIONS

## SUBSEA PRESSURE SENSOR RS232 MP AE

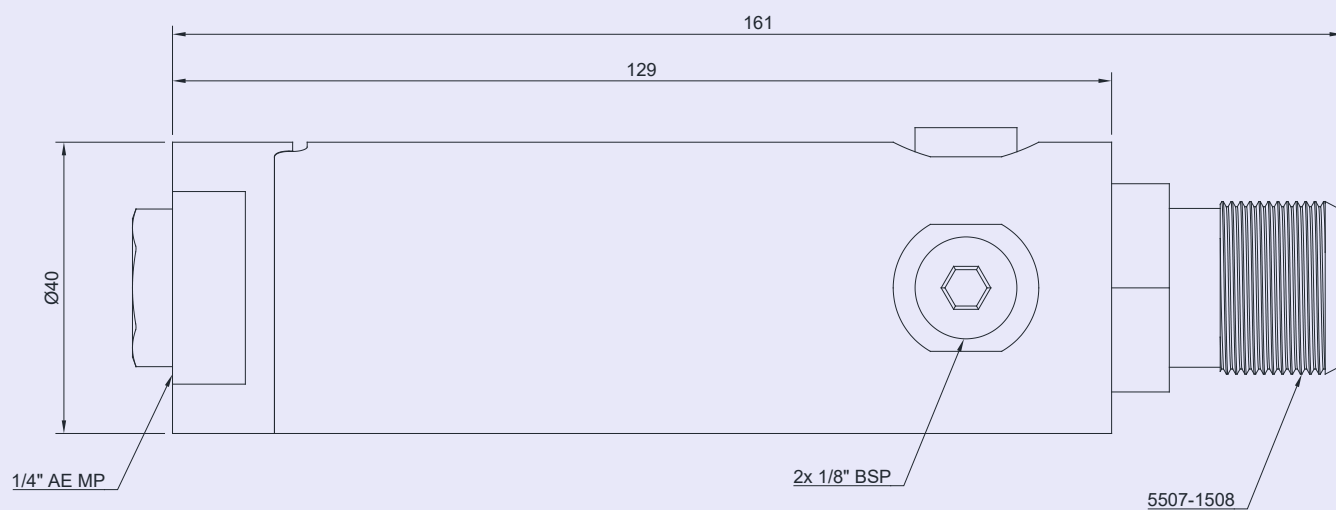

Face view

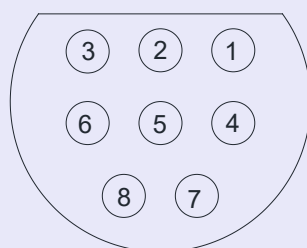

- 1: 0 V
- 2: 24 V DC
- 3: NC
- 4: NC
- 5: RS232 TX
- 6: RS232 RX
- 7: RS232 GND
- 8: NC

