

SPECIFICATIONS

SUBSEA PRESSURE SENSOR 4 – 20 mA



Description

The Subsea Pressure Sensor is available in a variety of pressure ranges and comes with a 4 – 20 mA interface.

The Subsea Pressure Sensor is designed for use in almost all subsea applications, and offers a reliable pressure measurement, even under harsh environmental conditions. Excellent vibration stability, robust construction, and a high degree of EMI protection equip the pressure transmitter to meet the most stringent industrial requirements.

Features

- 4 – 20 mA interface
- High accuracy
- Wetted parts made of stainless steel
- Compact and robust design
- Pressure ranges from 0 to 600 bar
- For temperatures up to 90 °C
- 3000-meter depth rating
- Service and user friendly

SPECIFICATIONS

SUBSEA PRESSURE SENSOR 4 – 20 mA

General Technical Specifications

Type		Subsea Pressure Sensor 4-20mA
Dimensions	mm	Ø40x161
Weight	g	~1000
Temperature Operational (ambient)	°C	-20 to +90
Temperature Storage	°C	-20 to +90
Temperature Media	°C	-40 to +125
Housing material		AISI 316L

Electrical

Supply Voltage	VDC	24VDC (8-30)
Power Consumption	W	~1W

Ordering Part Numbers

Description	Part Number
0 – 10 bar	121630
0 – 20 bar	118514
0 – 40 bar	121631
0 – 100 bar	118929
0 – 250 bar	109171
0 – 400 bar	117849
0 – 600 bar	118515

Accessories

Fitting BSP 1/8" Plug Hex w/Seal SS	118503
Fitting BSP 1/4" Plug Plastic	118504

SPECIFICATIONS

SUBSEA PRESSURE SENSOR 4 – 20 mA

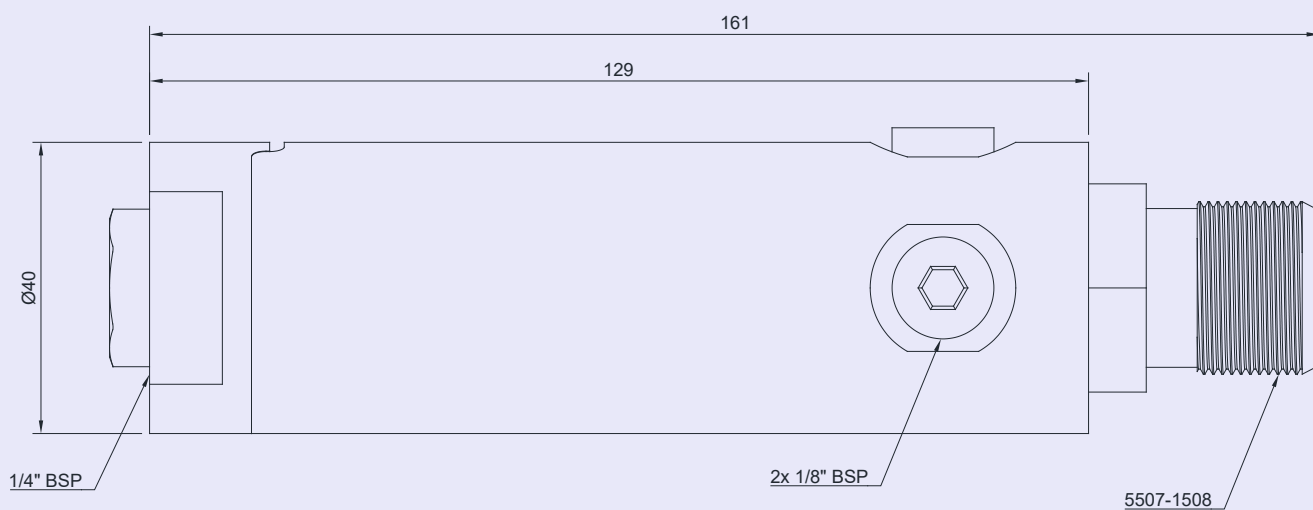

Face view

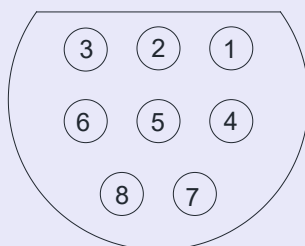

- 1: NC
- 2: 24 V DC
- 3: 4 - 20 mA
- 4: NC
- 5: NC
- 6: NC
- 7: NC
- 8: NC

