

SPECIFICATIONS

SUBSEA PRESSURE SENSOR RS232



Description

The Subsea Pressure Sensor is available in a variety of pressure ranges and comes with a serial RS232 interface.

The Subsea Pressure Sensor is designed for use in almost all subsea applications, and offers a reliable pressure measurement, even under harsh environmental conditions. Excellent vibration stability, robust construction, and a high degree of EMI protection equip the pressure transmitter to meet the most stringent industrial requirements.

Features

- RS232 serial interface
- High accuracy
- Wetted parts made of stainless steel
- Compact and robust design
- Pressure ranges from 0 to 600 bar
- For temperatures up to 70 °C
- 3000-meter depth rating
- Service and user friendly

SPECIFICATIONS

SUBSEA PRESSURE SENSOR RS232

General Technical Specifications

Type		Subsea Pressure Sensor RS232
Dimensions	mm	Ø40x161
Weight	g	~1000
Temperature Operational (ambient)	°C	0 to +70
Temperature Storage	°C	-20 to +70
Housing material		AISI 316L

Electrical

Supply Voltage	VDC	24VDC (11-30)
Power Consumption	W	~1W

Communication

RS232	kbps	9.6 – 230.4 (default 115.2)
-------	------	-----------------------------

Performance

Analog Input Resolution	bit	15 (32767)
-------------------------	-----	------------

Ordering Part Numbers

Description	Part Number
0 – 10 bar	121607
0 – 20 bar	118601
0 – 40 bar	121606
0 – 100 bar	121608
0 – 250 bar	118602
0 – 400 bar	118603
0 – 600 bar	118604

Accessories

Fitting BSP 1/8" Plug Hex w/Seal SS	118503
Fitting BSP 1/4" Plug Plastic	118504

SPECIFICATIONS

SUBSEA PRESSURE SENSOR RS232

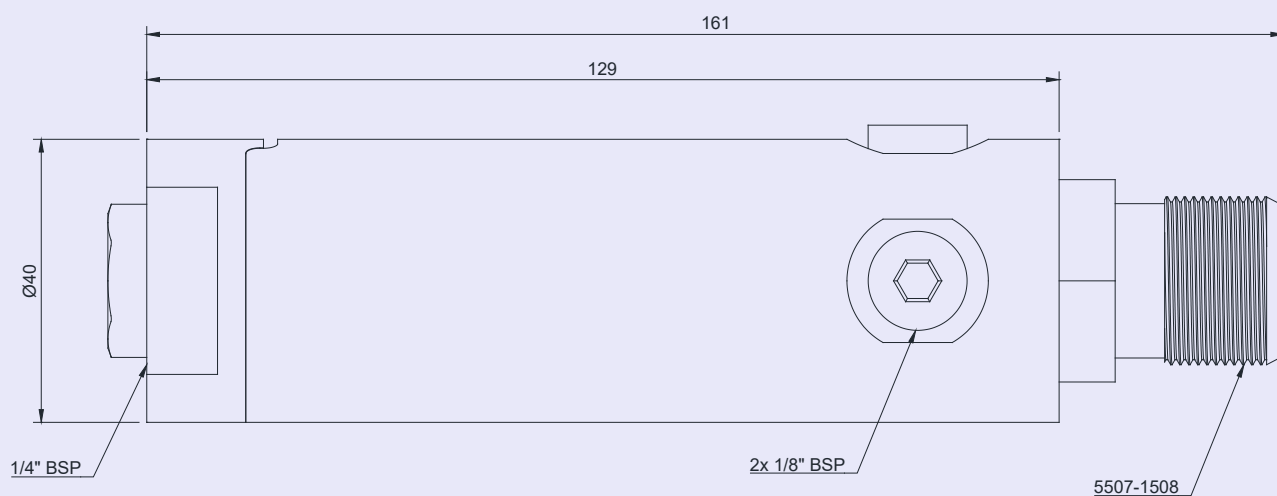

Face view

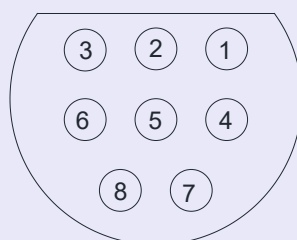

- 1: 0 V
- 2: 24 V DC
- 3: NC
- 4: NC
- 5: RS232 TX
- 6: RS232 RX
- 7: RS232 GND
- 8: NC

